

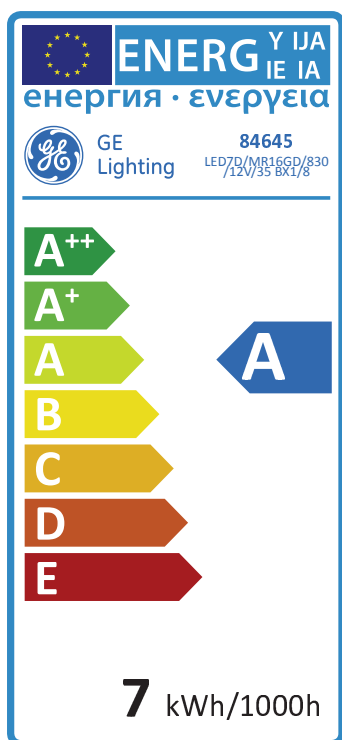

GE  
Lighting



7  
kWh/1000h

A  
energy class

56  
lumens/watt

## GE Precise™ MR16 Dimmable

LED7D/MR16GD/830/12V/35 BX1/8

# 84645

### Product information

GE's newest LED technology surpasses current market expectations for MR16 performance. Improved lumen output and an outstanding 45,000 hours life rating for a high quality halogen MR16 replacement. Available in three colour temperatures and two beam angles. The new Constant Colour™ 35W has a smooth heat sink and provide high colour consistency within 4 steps on the MacAdam ellipse. The new 50W has up to 15% higher lumen output.

### Application areas



Home



Retail



Office



Hospitality



WORLDWIDE PARTNER

## Product data

Cap/Base	G5.3
Bulb Shape	Mirrored reflector
Bulb Finish	Silver
Bulb Diameter [mm]	50
Bulb maximum overall diameter [mm]	50
Maximum Overall Length [mm]	51.15
Net weight per piece [g]	60
Gross weight per piece [g]	70
Brand	General Electric (GE)

## Performance data

Colour Rendering Index (CRI) [Ra]	82
Nominal correlated colour temperature (CCT) [K]	3000
Colour consistency	4 steps
Nominal beam angle [°]	35
Rated beam angle [°]	35
Nominal center beam candlepower (CBCP) [cd]	1100
Rated peak intensity in [Cd]	1100
Nominal lumens [lm]	390
Nominal useful lumens [lm]	420
Useful lumens (at 90° cone) [lm]	390
Energy efficiency class (EEC)	A
Rated life L70/B50 [h]	45000
Weighted energy consumption [kWh/1000h]	7

## Electrical data

Nominal power [W]	7
Rated power [W]	7.0
Nominal lamp power factor	0.9
Nominal lamp voltage [V]	12
Lamp Current [A]	620mA
Operating Temperature (MAX) [°C]	40
Run-up time (sec)	<0.5s
Starting time [sec]	<0.5s
Number of switching cycles	90000
Dimming Capability	Yes

## Logistic data

DUN Code	10043168846452
EAN Code	0043168846455
Pack Quantity	8
Inner pack type	HANGING BOX
Outer pack type	OUTER BOX
Layer quantity	216 EUR, 288 UK
Layer quantity EUR	216
Layer quantity UK	288
Pallet quantity EUR (PC)	2808
Pallet quantity UK (PC)	3744
Outer case size	239x121x65 mm
Product status	Available

## Technical drawing

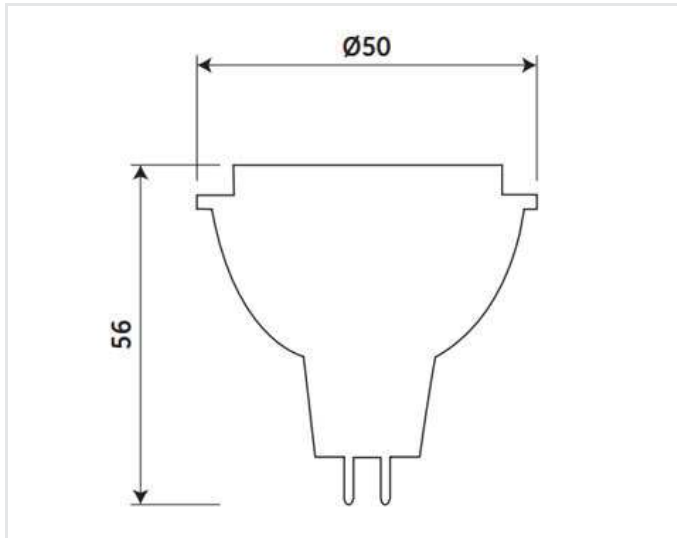

## Downloads & Links

[Go to the catalog site \(HTTP\)](#)

[LED Lighting Solutions - Catalogue \(PDF\)](#)

[Lighting design tools & calculators \(HTTP\)](#)

[Datasheets \(HTTP\)](#)

[High-res images / Technical drawings \(HTTP\)](#)

[Certificate for the Quality Management System of GE Lighting EMEA \(PDF\)](#)

[Certificate for the Environmental Management System of GE Lighting EMEA \(PDF\)](#)