

# Luna COB 8" Downlight 35W

cutout 200mm

## Description

Luna COB 8" Downlight is designed to be rotatable 358° in horizontal and 60° in vertical direction, could meet various need on emitting directions. It is 35W including driver and delivers 4200lm of 80+ CRI warm white light while achieving up to 120lm/W. This outstanding performance is achieved by one 40W COB with Epistar chip. Its pending patent design especially the heat sink make sure perfect heat dissipation and low temperature on light body.



## Features

1. Use die-casting aluminum alloy as the material of main-body.
2. Use high transparent PMMA as lens.
3. Unique and beautiful looking design.
4. Excellent heat dissipation performance.
5. Isolated driver, ensure the long life span.
6. Energy-saving and high efficient LED driver.
7. Isolated driver design.
8. The lamp is 358° rotatable horizontally and 30° vertically



## Specifications

Model #	CCT	LED Type	Lumen(lm) (±10%)	CRI	Power(W) (±10%)	Beam angle	Current	Voltage (V)	PF
MDL8-035-AW-W-01	5000K	COB ( Epistar chip )	4360	>80	35W	90°	<0.40A	100-240V AC	>0.92
MDL8-035-AW-NW-01	4000K		4300						
MDL8-035-AW-WW-01	3000K		4200						

## Dimensions (Unit: mm/inch)

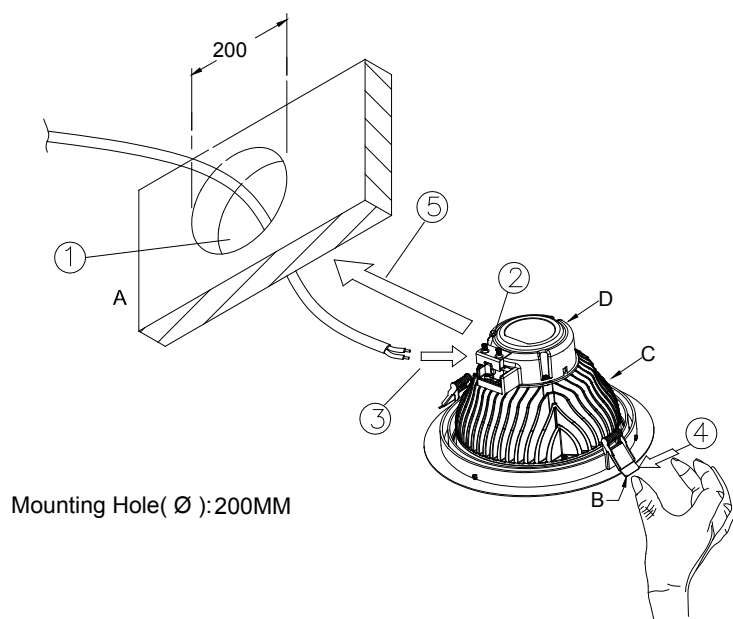
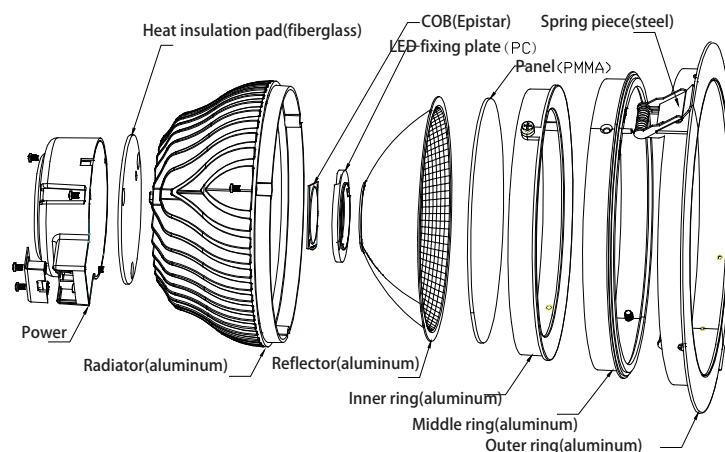
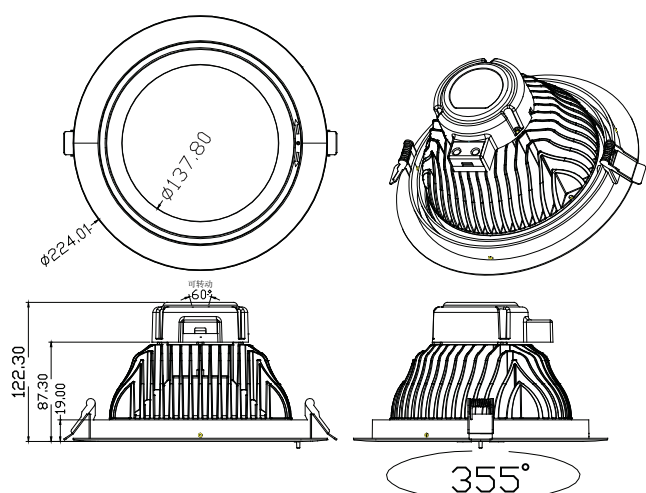

①	make a hole
②	Open driver cover
③	connect the power wire
④	push spring
⑤	put the lamp into the hole

A	Wall
B	Spring
C	LED lamp
D	Driver